

House & Land Package

\$659,000



Beachgrove

Lot 471 | 27 Croucher St

2 2 1 1

Section: 276m² Home: 108m²



Enjoy quality, comfort and peace of mind in this thoughtfully designed new home by Trident Homes. Featuring premium Fisher & Paykel appliances, fully landscaped grounds and enhanced energy efficiency with 8mm IBS RidgidRap wall underlay, this home is built to a high standard throughout. A stylish low-maintenance home offering modern living and exceptional value.

- Clad in low maintenance brick with Axon feature panels.
- Heat Pump with WiFi.
- Custom-designed kitchen with Fisher & Paykel Appliances.
- Quality Methven Tapware.
- Master bedroom with Ensuite.
- Quality floorcoverings.
- Driveway, paths, patios and landscaping.

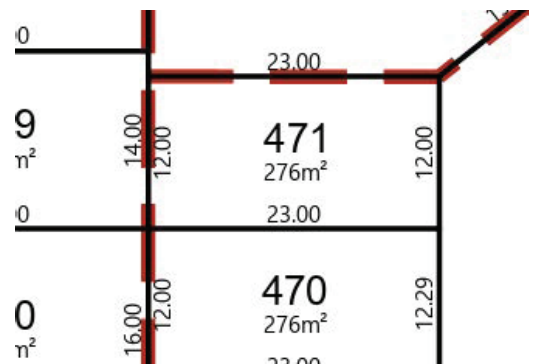

TRIDENT HOMES[®]

Designed for living. Built for life.

2 2 1 1

Section: 276m² Home: 108m²

Floorplan



Location

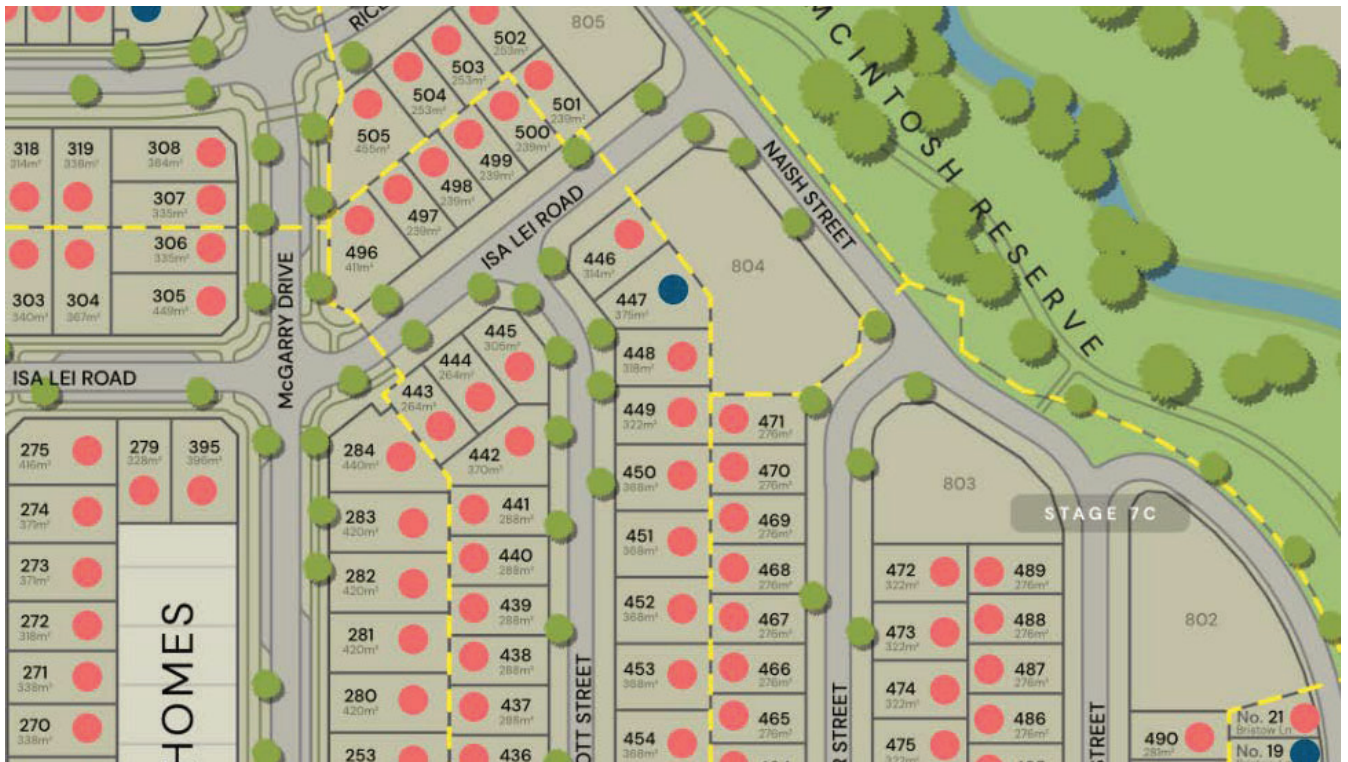

For more information on this Package and inclusions contact Trident Homes Christchurch

Rebecca Dobson rdoobson@tridenthomes.nz
027 557 4243

www.tridenthomes.nz

Pictures and plans on this brochure are artist's impressions only and may show items not included in the building contract. Please note that only items contained in the specification sheet in your building contract will be included. Please ensure you discuss this with your builder. All plans are subject to copyright to Trident Homes NZ.



Designed for living. Built for life.